

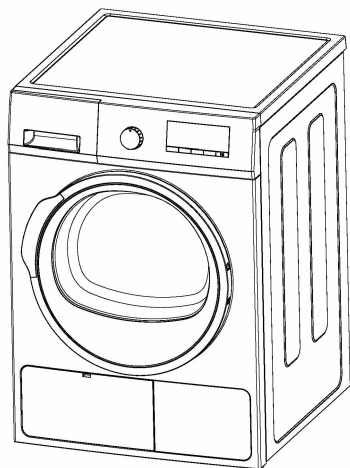

# HEAT PUMP DRYER

## User's Manual



**Model:  
TCD80ASHAG**

### **IMPORTANT NOTE:**

Thank you for selecting a TECO quality Dryer. Read this manual carefully before installing or operating your new unit. Make sure to save this manual for future reference.

The design and specifications are subject to change without prior notice for product improvement. Consult with the sales agency or manufacturer for details.



# PREFACE

**Thank you for choosing our dryers. Please read this manual carefully. It provides instruction, use, and maintenance. Retain it for future reference. Record the model and serial numbers of your machine. Quote this information to your dealer if you require service.**

**The following symbols are used in this manual:**

 **Important information concerning your personal safety and information on how to avoid damaging the appliance**

 **General information and tips**

 **Environmental information**

## WARNING

Read and understand thoroughly these safety instructions before use. The items indicated here are very important safety precautions, which must be followed. We cannot be held liable for damage caused by non-compliance with the warning and safety instructions resulting from incorrect use or operation.

This appliance is not intended for use by persons (including children) with reduced physical, sensory or mental capabilities or lack of experience and knowledge unless they have been given supervision or instruction concerning use of the appliance by a person responsible for their safety.

Children should be supervised to ensure that they do not play with the appliance.

Packaging (e.g. wraps, polystyrene, etc.) can be dangerous for children. There is a risk of suffocation. Keep packaging materials away from children.

## Possible Electric Shock

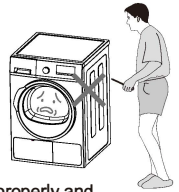

- Disassembly, repair or modification can't be carried out by people other than professional maintenance staff.
- The household electrical supply system (the current, the voltage, the cable) such as a fuse with the specifications and safety details provided refer to "normal load" operation.
- The power plug must be connected to a three-core socket with an earth wire and is grounded properly and reliably.
- If the supply cord is damaged, it must be replaced by the manufacturer, its service agent or similarly qualified persons in order to avoid a hazard.
- Don't disconnect the power plug by pulling the supply cord. Hold the power plug with your hand.
- Don't use the supply cord when connection of the power plug and the supply cord is loose.
- Don't touch the power plug with wet hands. Wipe dust or water drops over the power plug of f with a dry cloth.
- Don't over-bend the supply cord or put it under heavy weight.
- Don't use the supply cord /socket /power plug if it is damaged or broken.

## Possible Explosions

- Don't put combustible liquid such as gasoline, petrol and alcohol into the appliance or nearby. Don't put clothes with these liquids into the appliance.
- Don't connect / disconnect the power plug when leakage of gas or other combustible gas occurs.

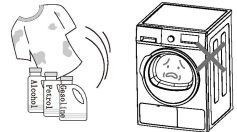

## Fire Accidents/Short Circuit Or Electric Leakage May Occur

- Do not install the appliance close to fire sources or heat sources.
- Do not rest any burning candles or cigarettes on the appliance.
- Do not install the appliance in areas prone to dampness or rainfall as water on the electrical components can damage the appliance and/or cause accidents.
- Do not install the dryer in places in direct sunlight, the plastic and rubber components become brittle and aged.
- Do not use water jets on the appliance when cleaning it.
- In order to avoid danger of fires caused by excessive drying, do not use the appliance to dry the following items: Cushions, quilts and the like (these items accumulate heat).
- When using stain remover on your laundry, ensure you run an extra rinse cycle prior to loading into the tumble dryer.
- Ensure all pockets are empty prior to loading laundry into the tumble dryer.
- Items that have been soiled with substances such as cooking oil, acetone, alcohol, petrol, kerosene, spot removers, turpentine, waxes and wax removers should be washed in hot water with an extra amount of detergent before being dried in the tumble dryer.
- Ensure the openings in the base are not obstructed by carpets.
- The hot air discharge from the dryer cannot be shared with other exhaust passages from devices that burn gases or other fuels.

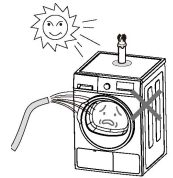



## Warning

- In the appliance enclosure or in the built-in structure, keep ventilation openings clear of obstruction.
- Do not damage the refrigerant circuit.
- Never stop a tumble dry before the end of the drying cycle unless all items are quickly removed and spread out so that the heat is dissipated.
- The appliance must not be supplied through an external switching device, such as a timer, or connected to a circuit that is regularly switched on and off by a utility .

## Personal Injury May Occur

- This machine is not intended for use by persons (including children) with reduced physical, sensory or mental capabilities, or lack of experience and knowledge, unless they have been given supervision or instruction concerning use of the appliance by a person responsible for their safety.
- To avoid danger to children, ensure all packaging is disposed of safely.
- Ensure children under 3 years of age are supervised.
- Wait until the drum has stopped completely prior to removing laundry from the dryer.
- Children and pets should be kept away when the dryer is working to ensure they do not become trapped. check the drum carefully before closing the door .

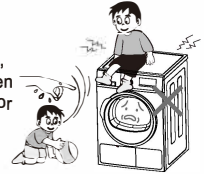

Always

## Other Instructions

- This appliance is designed for domestic use. It must not be used for purposes other than those for which it was designed.
- Only wash fabrics which are designed to be machine dried. Follow the instructions on each garment label.
- Any electrical work required to install this appliance should be carried out by a qualified electrician.
- If the machine is situated on a carpeted floor, please adjust the feet in order to allow air to circulate freely under the appliance.
- Do not climb onto the dryer or rest heavy objects / heating devices or items with water or anything that could leak on the dryer, deformation of the face panel and the plastic component could occur.
- Any objects such as coins, safety pins, nails, screws, stones or any other hard, sharp material can cause extensive damage and must not be placed into the machine.
- After having installed the appliance, check that it is not pressing or standing on its electrical supply cable, or vent hose.
- Items such as foam rubber (latex foam), shower caps, waterproof textiles, rubber backed articles and clothes or pillows fitted with foam rubber pads should not be dried in the tumble dryer.
- Always unplug the appliance after use, clean and perform regular maintenance. .
- Do not overload the appliance. See the relevant section in the user manual.
- Clothes which are dripping wet should not be placed in the dryer.
- Garments which have been in contact with volatile petroleum products should not be machine dried. If volatile cleaning fluids are used, care should be taken to ensure that the fluid is removed from the garment before placing in the machine.
- Never use the tumble dryer if the power supply cable, the control panel, the working surface or the base are damaged so that the inside of the tumble dryer is accessible.
- The tumble dryer is not to be used if industrial chemicals have been used for cleaning.
- The lint must not be allowed to accumulate around the tumble dryer.
- Do not dry unwashed items in the tumble dryer.
- Fabric softeners or similar products should be used as specified by the fabric softener instructions.
- The final pat of a tumble dryer cycle occurs without heat (cool down cycle) to ensure that the items are left at a temperature that ensures that the items will not be damaged.
- The exhaust air must not be discharged into a flue or duct which is used for exhausting fumes from appliances burning gas or other fuels.
- That the appliance must not be installed behind a lockable door, a sliding door or a door with a hinge on the opposite side to that of the tumble dryer, in such a way that a full opening of the tumble dryer door is restricted.
- The machine must be placed in a clean place with no water, ice and combustible materials. To keep vibration and noise to a minimum when the dryer is in use, it should be placed on a firm and level surface.
- If the tumble dryer is not completely leveled, adjust the front feet up. To lower the dryer, turn anti-clockwise and to raise it, turn clockwise until the appliance is level preventing it from shaking.
- Adequate ventilation has to be provided to avoid the back flow of gases into the room from appliances burning other fuels, including open fires.

- Items that have been soiled with substances such as cooking oil, acetone, alcohol, petrol, kerosene, spot removers, turpentine, waxes and wax removers should be washed in hot water with an extra amount of detergent before being dried in the tumble dryer.
- Remove all objects from pockets such as lighters and matches.
- Oil-affected items can ignite spontaneously, especially when exposed to heat sources such as in a tumble dryer. The items become warm, causing an oxidation reaction in the oil.
- Oxidation creates heat. If the heat cannot escape, the items can become hot enough to catch fire. Piling, tacking or storing oil affected items can prevent heat from escaping and so create a fire hazard.
- If it is unavoidable that fabrics that contain vegetable or cooking oil or have been contaminated by hair care products be placed in a tumble dryer they should first be washed in hot water with extra detergent - this will reduce, but not eliminate the hazard.
- This dryer has an hermetically sealed system.
- Do not vent gases into the atmosphere.
- Refrigerant(Type):R134A (GWP=1430).
- If the supply cord is damaged, it must be replaced by TECO service agent or similarly qualified persons in order to avoid damage to the appliance or hazards.
- The appliance must not be installed behind a lockable door, a sliding door or a door with a hinge on the opposite side to that of the tumble dryer, in such a way that a full opening of the tumble dryer door is restricted.

## Product description

1. Control Panel
2. Water Tank
3. Fluff filter
4. Door
5. Condenser cover
6. Adjustment leg

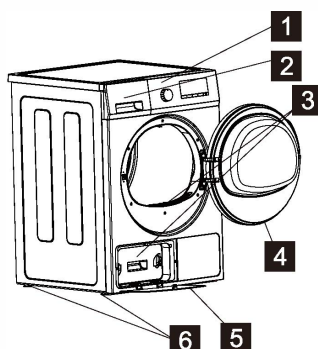

## Control panel

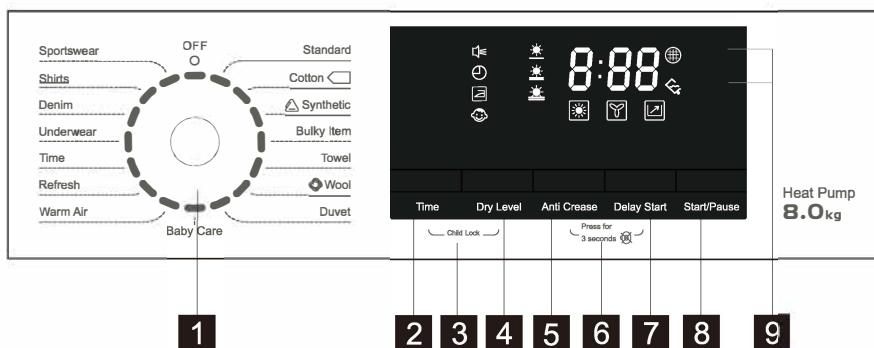

- 1
- 2
- 3
- 4
- 5
- 6
- 7
- 8
- 9

- |                             |                |                |                      |                |
|-----------------------------|----------------|----------------|----------------------|----------------|
| 1. Programme selection knob | 2. Time        | 3. Child Lock  | 4. Dry level         | 5. Anti-crease |
| 6. Buzzer                   | 7. Delay start | 8. Start/Pause | 9. Indicator Lights: |                |
|                             |                |                | Drainage container   |                |
|                             |                |                | Fluff filter         |                |

## **i** First Use

- Ensure that the electrical connections comply with the installation instructions.
- Remove the polystyrene block and any material from the drum.
- Before using your tumble dryer for the first time, we recommend that you place a few damp cloths inside the appliance and dry for 30 minutes. There may be dust inside a brand new tumble dryer.

## **i** Daily Use

### **Connect the appliance**

- Open the door
- Place the laundry in the drum, one item at a time, shaking them out as much as possible.
- Close the door. Please check the laundry does not get caught between the door and filter.



## **Select The Required Program**

- Turn the program selector dial to the required program. The Start/Pause light starts to flash. The program will be switched off if you have not pressed any button for 10 minutes.

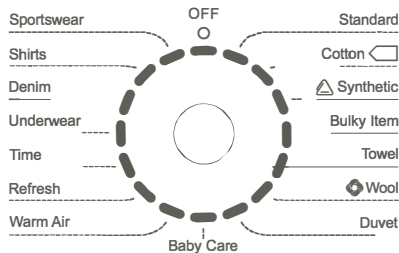

### **Attention:**

- "Standard" is for the "standard cotton program". Standard program is suitable to dry normal wet cotton laundry, and it is the most efficient program in terms of energy consumption for drying wet cotton laundry.
- Some thick clothes (jeans & towels). Because of the material characteristics, some items are difficult to dry. If you find that they are not completely dry at the end of the program, it is recommended to use the "Time" program to dry again.

## **Automatic Controlled Drying**

- You can choose a different program based on your clothes materials. The dryer has the function that can sense the moisture in order to automatically adjust the drying time for optimal drying.
- This automatic control system is fit for most programs except Warm Air, Refresh and Time.

## **Time Controlled Drying**

- You can choose the time of drying according to the actual situation, the knob is turned to Time, and you can also increase it to the desired time by pressing the Time button.
- To cancel a program which is running, turn the program selector dial to "off". At the end of drying, turn the selector dial to "off" to switch the machine off before removing the laundry.

## **Programme Option Buttons**

- Depending on the program, different functions can be combined. These must be selected after choosing the desired program and before depressing the Start/Pause button. When these buttons are pressed, the corresponding indicator lights comes on. When they are pressed again, the indicator lights go off.

## Select Buzzer

- The buzzer can be selected during normal use. Press the “Buzzer” button to turn off the buzzer and corresponding light. Press once again to activate the buzzer and corresponding light. A sound will be emitted.
- The “Buzzer” key is pressing Anti Crease and Delay Start at the same time for 3 second.

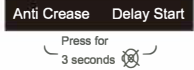

When the buzzer is on, if you press the “buzzer” button once more, the buzzer will be switched off.

## Select the Dry level

- Before you start the machine, you can choose the dry level. The dry level is divided into three grades. ( Heavy Strong Normal )
- This option is only suitable to the five programs: Daily, Cotton, Synthetic, Bulky Item, Towel.

## Select Anti Crease

Anti-crease is a default setting at the end of each program. Longer Anti-crease can be selected while the program is in standby or running.

## Select Delay start

This button allows you to delay the start of the program by up to 24 hours (each time the button is pressed the time is increased by 1 hour). This option must be selected after setting the required program and before pressing Start/Pause to commence drying. When Start /Pause is pressed, the corresponding indicator lights start to flash and countdown begins.



The countdown begins after you have pressed the Start/Pause button. The corresponding light illuminates when you have pressed this button. All indicator lights go out except Delay Start pilot light.

## Display

The display shows the following information :

After you have selected the program, its duration (in hours and minutes) appears on the display. It is calculated automatically on the basis of the maximum load accepted for each type of fabric and of the required degree of drying. When the program starts, the remaining time is displayed every 1 minute.

- **Delayed Start.**

If you have selected a delay time by means of the relevant button, the display shows it. The countdown is displayed hour by hour. Once you press the “Start/Pause” button, the appliance will start the delayed process. If you want to check the selected program, press the “Delay Start” button again. It shows the duration of the previously selected program.

- **Incorrect option selection**

If you select an option that is not compatible with the program you have selected, the display shows ErS (error) . If you select other program because of incorrect operation while the program is running, the display shows ErS (error) .

## Select Start/Pause

Select the required program options and press the Start/Pause button to commence drying. The dryer will pause after pressing the button again or opening the door while the program is running. When the machine is suspended, Program Selection Dial and other keys are invalid except Start/Pause, Anti Crease and Buzzer keys. To re-start the program, press the Start/Pause button once again.

## Indicator lights

- These lights indicate the following functions:
- Drying light "☀️". This light indicates that the appliance is in the drying phase.
- Cooling light "❄️". This light indicates that the appliance is in the cooling phase. At the end of drying, there is a two minute cooling phase to cool the laundry.
- End of program light "🏠". This light is on at the end of the cooling phase.
- Anti-creasing light "🧺". This light indicates the appliance is in the anti-crease phase:
- If selected, the Anti-Crease program light will be on before Anti-Crease program the light will flash while the program runs; If not selected, the Anti-Crease program light will flash during default anti-crease cycle.
- Filter light "🌀". It comes on every cycle to remind you that the filter must be cleaned at the end of the program.
- Child Lock light "🔒". This light indicates the appliance is locked.
- Buzzer light "🔊". This light is on when buzzer program is selected.
- Delay Start light "⌚". This light is on when delay start program is selected.
- Drying Type light "☀️ 🌿 🌱". These lights will be on when Dry Level function is selected. When you choose different drying intensities, the corresponding indicator light turns on.
- Tank full light "💧". It comes on after each program and also when the water tank is full, which remind you to empty the water container Note: Empty the water container after each program to avoid the alarm when use in next time.

## At The End Of The Program

All drying programs will end with a 2-minute cooling phase.

If the laundry is not removed at the end of the cycle, the dryer will run an anti-crease phase (default: 10 minutes, select: 120 minutes). If you do not remove the laundry, the dryer will stop automatically at the end of the anti-crease phase. The display shows "End" and the buzzer sounds for 15 seconds when the buzzer function is on. To finish, turn the programme selector dial to off.

## Child Lock Function

When the machine is on, press "Time" and "Dry level" buttons for several seconds, the system will lock all the buttons. Then all buttons are invalid except "off". If you want to make the appliance to return to the normal state, then press "Time" and "Dry level" buttons for several seconds again.

The ● function on the dial will be door release during operation in the following cases:

- Open the door during operation.
- Take out filter drawer during operation
- Water tank full

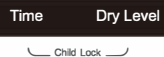

You can set again the "Child Lock" function when you restart the machine.

## After Each Use

**Important :** If the drying program has to be stopped before it reaches the end, we recommend that you turn the program selector dial to position "Refresh" and wait until the end of this cooling phase before removing the laundry. This will avoid a build-up of heat inside the appliance.

To do this first turn the dial to "off" and then to "Refresh" and press the "Start" button.

### Modifying the program

To change a program which is running, first cancel it by turning the program selector dial to "off". Select the new program and press the "Start" button.

**Attention:** The display will show "-" when in dormant state; - standby mode, 10 minutes later, without any operation, enter a dormant state.

- controller shows "End", 10 minutes later, without any operation, enter a dormant state.



## Before Loading Laundry

Never tumble dry the following: Particularly delicate items such as net curtains, woolen, silk, fabrics with metal trim, nylon tights, bulky materials such as anoraks, blankets, eiderdowns, sleeping bags, feather quilts and any items containing rubber foam or materials similar to rubber foam.

- Always follow the instructions on garment labels:



May be tumble dried



Delicate drying (low temperature)



Normal drying (high temperature)



Do not tumble dry



- Close pillowcases and covers with fasteners to prevent small laundry items getting tangled inside them. Close press studs, zips, hooks, tie belts and apron strings. Sort laundry according to type and degree of drying required.
- Do not over-dry laundry, this avoids creasing and saves energy.
- Avoid drying dark clothes with light coloured fluffy items such as towels as they could attract fluff.
- The laundry must be thoroughly spun before tumble drying.
- Easy-care items, e. g. shirts, should be briefly pre-spun before drying.
- Knitted textiles (knitted underwear) may shrink a little after drying. Please do not over-dry items of this type. It is advisable to allow for shrinkage when choosing the size of new purchases.
- You can also put starched items into your dryer. However, to achieve the desired starched effect, choose the program "Iron dry". To remove any starch residues, wipe out the internal drum after drying with a moist cloth and then rub dry.
- To avoid a static charge when drying is completed, use either a fabric softener when you are washing the laundry or a fabric conditioner specifically for tumble dryers.
- Remove the laundry when the dryer has finished drying.
- If individual items are still damp after drying, set a brief post-drying time, for at least 30 minutes, this will be necessary particularly for multilayered items (e.g. collars, pockets, etc.)

**Make sure that no metal objects are left in the laundry (e.g. hair clips, safety pins, pins, etc.)**

Button up pillowcases, close zip fasteners, hooks and poppers. Tie any belts or long tapes. To avoid laundry becoming tangled:

Close zips, button up duvet covers and tie loose ties or ribbons (e.g. of aprons).

Turn items with double-layered fabrics inside out (e.g. with cottonlined anoraks, the cotton layer should be outermost). These fabrics will improve the drying process.

Remove all objects from pockets such as lighters and matches .

**Maximum Loads**

Recommended loads are indicated in the program charts :

General rules: **Cotton, linen** : drum full but not too tightly packed ;  
**Synthetics** : drum no more than half full;

**Delicate fabrics and woollens** : drum no more than quarter full.

Try to load the maximum capacity of the machine as small loads are uneconomical.

Course	Max load	Description of programme
Standard	8kg	Blend materials usual clothes and so on. It is possible to choose different drying strength.
Cotton 	8kg	Cotton clothes and so on. It is possible to choose different drying strength.
Synthetic	4kg	Chemical fiber products and so on. It is possible to choose different drying strength.
Bulky Item	8kg	To dry the larger clothes. (bedsheet, Quilt cover) It is possible to choose different drying strength and so on.
Towel	4kg	Towel. It is possible to choose different drying strength.
Wool	2kg	Knitted sweater and so on.
Duvet	3kg	Down jacket.
Baby Care	3kg	Baby clothes.
Warm Air	4kg	Used for drying delicate material loads, such as silk, etc. The machine dries depend on the display time, regardless of the drying level.
Refresh	4kg	The clothes are deodorizing and fresh, and the intensity of drying is weak. The machine dries depend on the display time, regardless of the drying level.
Time	8kg	Drying thick or multi-layered textiles, the machine dries depend on the display time, regardless of the drying level. e.g. terry towelling items. For drying individual items of laundry or for small volumes.
Underwear	2kg	Underwear.
Denim	4kg	Denim.
Shirts	2kg	Shirts .
Sportswear	2kg	Sportswear.

Note: For drying bathrobes and towels, do not exceed the max load of 6kg.

## Laundry Weights

The following weights are indicative:

Bathrobe	1600g	Night Dress	265g
Napkin	130g	Ladies' Briefs	130g
Quilt Cover	930g	Men's Work Shirt	800g
Sheet	665g	Men's Shirt	265g
Pillow Case	266g	Men's Pyjamas	130g
Tablecloth	330g	Blouse	665g
Towelling Towel	265g	Men's Underpants	130g
Tea Cloth	130g		

## Care and Cleaning

- You must DISCONNECT the appliance from the electricity supply before you can carry out any cleaning or maintenance work.
- Don't clean the dryer by directly spraying water onto the dryer. Don't clean the dryer with benzene, thinner, alcohol or acetone. Otherwise, it may cause discoloration, deformation, damage, electric shock or fire.
- When cleaning the product, be sure to unplug the power cord.  
Durning the drying cycle, the control panel or the door may accumulate moisture.

### Control Panel

- Clean with a soft, damp cloth. Do not use abrasive substances.
- Don't spray cleaners directly on the panel.
- The control panel finish may be damaged by some laundry pre-treatment soil and stain remover products.
- Apply such products away from your dryer and wipe up any spills or overspray immediately.

### Stainless Steel Tumbler

- To clean the stainless steel tumbler, use a damp cloth with a mild, non-abrasive cleaner suitable for stainless steel surfaces.
- Remove the cleaner residue and dry with a clean cloth.

### Cleaning the door

Clean periodically the interior part of the door to remove any fluff. Accurate cleaning ensures correct drying.

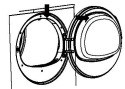

### Cleaning The Filter

- Open the loading door.
- Remove the lint filter by putting it up and open the lint filter.
- Clean lint, fibre, and cotton raveling by hand or with a soft piece of cloth.
- Close the lint filter and place it back into its housing.
- A layer can build up on the filter pores that can cause clogging of the filter after using the dryer for a while. Wash the lint filter with warm water to remove the layer that builds up on the lint filter surface. Dry the lint filter completely before reinstalling it.
- The lint trap has to be cleaned frequently.

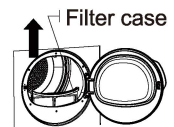

Always clean the lint filter and the inner surfaces of the loading door after each drying process.

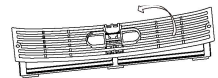

### Humidity Sensor

This auto sensing dryer uses a humidity sensor that requires cleaning to function efficiently as calcium oxide may build up on the sensor surface.

1. Remove and clean the filter.
2. Locate the humidity sensor in the filter compartment and gently clean the humidity sensor with a dry cloth (refer to image on right).



## Water container emptied

Water container collects all of the water from condenser. The container needs to be emptied after every drying cycle. If the water container is full, an active program will stop automatically. The  light will come on and the buzzer sounds. In order to continue the program, the water container must be emptied and dry.

### 1. Pull out water container



### 2. Tip water into pool

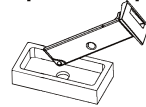

### 3. Pull the water container

### 4. Press the Start/Pause button

## Clean the filter drawer

Lint and fibre that could not be captured by the lint filter are blocked in the filter drawer behind the cover. Clean the filter drawer after each drying process. There is a two-level filter in the filter drawer. The first level is the filter drawer sponge and the second level is the filter cloth.

- Press the button to open the cover.
  - Unlock the fixer.
  - Pull out the filter drawer.
  - Clean lint, fiber and cotton collecting on the filter cloth by hand or with a soft piece of cloth.
  - When you notice a layer that may cause clogging on the filter cloth, clean the layer by washing with warm water. Leave to dry completely before installing the drawer.
- Wash the filter drawer sponge by hand to remove the fiber and lint on the surface. After washing the sponge, squeeze it and remove excess water. Dry the sponge before replacing.

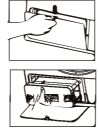

## Dryer Exterior

- The whole dryer has a high-gloss finish. Clean with a soft, damp cloth. Don't use abrasive substances.
- Protect the surface from sharp objects as they may scratch or damage the finish.
- Don't place any heavy or sharp objects or a detergent box on the dryer. Keep them on a pedestal or in a separate storage box.

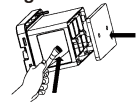

Warning

**Do Not Use The Appliance Without a Filter**

## Clean the evaporator

- Clean the lint accumulated on the fins of the evaporator located behind the filter drawer with a vacuum cleaner or a soft brush. You can also clean by hand provided that you wear protective gloves.
- It is recommended to clean it at least twice every month.



Warning

Evaporator fins are sharp. Clean using a soft brush only.

**IMPORTANT** : If you call a technician for a fault listed below or to repair a fault caused by incorrect use or installation, a charge will be made even if the appliance is within the warranty period.



## Technical data

Dryer Model	TCD80ASHAG
Dryer Capacity(kg)	8.0
(AC V/Hz)	220-240/50
Rated power (W)	650
Weight(kg)	46
Power(left-on mode)(W)	0.36
Power(off mode)(W)	0.4
Energy consumption at full load(kWh)	2.9
Programme time at full load(min)	290
Dimensions(H x W x D)(mm)	850 x 595 X 630
Ambient temperature range(°C)	5 ~ 35

## NOTE

The above data in the table is based on using the "Standard" program which has been tested according to AS/NZS 2442.2:2000 + A1: 2006 + A2: 2007 standards. This data may vary based on different laundry types, residual moisture, environmental conditions and voltage fluctuation.

- **Check accessory:** Open the accessory bag and check the accessories.

Accessory	Name	Quantity
	drainpipe	1
	manual	1

## Something not working?

Malfunction	Possible Cause	Solution
Dryer does not work	<ul style="list-style-type: none"> <li>● Mains plug is not plugged in.</li> <li>● Loading door is open.</li> <li>● Have you pressed the▶   button?</li> </ul>	<ul style="list-style-type: none"> <li>● Plug in at main socket.</li> <li>● Close loading door.</li> <li>● Press the▶   button again.</li> </ul>
Drying results unsatisfactory	<ul style="list-style-type: none"> <li>● Wrong programme selected.</li> <li>● Filter clogged.</li> <li>● Incorrect volume of laundry.</li> <li>● The sediment on humidity sensor.</li> </ul>	<ul style="list-style-type: none"> <li>● Select a different programme the next time you dry(see "Drying Programme "section).</li> <li>● Clean lint filter.</li> <li>● Observe recommended loading volumes.</li> </ul>
Drum light does not work(option)	<ul style="list-style-type: none"> <li>● Light bulb is defective.</li> </ul>	<ul style="list-style-type: none"> <li>● Replace light bulb.</li> </ul>
Drying cycle ends shortly after programme starts. "END" light illuminated.	<ul style="list-style-type: none"> <li>● Not enough washing loaded or washing load is too dry for selected programme.</li> </ul>	<ul style="list-style-type: none"> <li>● Select higher drying level(e. g. Heavy instead of Strong)</li> </ul>
Drying cycle lasts an unusually long time	<ul style="list-style-type: none"> <li>● Load volume is too big.</li> </ul>	<ul style="list-style-type: none"> <li>● Reduce load volume.</li> </ul>

- i** If you are unable to identify or solve the problem, contact our service center. Before telephoning, make a note of the model, serial number and purchase date of your machine: the Service Center will require this information.

## Earth note

This appliance must be earthed. In case of failure or damage, earth can provide a minimum resistance to reduce the possibility of electric shock. The power cord has grounding wire with device and power cord with plug. Plug must be inserted into a properly installed and grounded socket(in accordance with all local rules and standards).

## Water discharge

It's not necessary to discharge the condensed water to the tank, it can be drained out directly.  
**change drainpipe**

Pull out the water pipe by means of the arrow direction, Then install the drainpipe.  
A pair of pliers may be used if it is difficult to do.

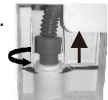

## Removing transport safety packaging foam

### ⚠ Caution!

Before use of the machine, the packaging foam must be removed from the drum. 1.Open the loading door.  
2.Pull off adhesive strips from inside machine on top of drum.  
3.Remove the two packaging foam from the machine.

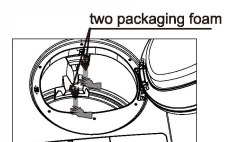

### Check the dryer is level

Press on either front corner, the machine should not move up and down.(please check both corners) when press on the top frame (both corners), if it moves, re-adjust the adjustable feet.

Do not place stacks of blankets or a rope on the floor, which could generate some heat and affect how the machine runs.

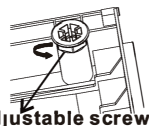

**▲ IMPORTANT:**The hot air emitted by the tumble dryer can reach temperature of up to 60°C.The appliance must therefore not be installed on floors which are not resistant to high temperatures.

### Electrical Connection

Any electrical work required to install this appliance should be carried out by a qualified electrician or competent person.

**▲ Warning | THIS APPLIANCE MUST BE EARTHED**

**▲** The manufacturer declines any liability should this safety measure not be observed.

Before switching on, make sure the electricity supply voltage is the same as that indicated on the appliance's rating plate.



### Packaging materials

- The materials marked with the symbol  are recyclable.
  - >PE<=polyethylene
  - >PS<=polystyrene
  - >PP<=polypropylene
- This means that they can be recycled by disposing of them properly in appropriate collection containers.
- Old machine

Use authorized disposal sites for your old appliance. Help to keep your country tidy!

● The symbol  on the product or on its packaging indicates that this product may not be treated as household waste. Instead it should be taken to the appropriate collection point for the recycling of electrical and electronic equipment. By ensuring this product is disposed of correctly, you will help prevent potential negative consequences for the environment and human health, which could otherwise be caused by inappropriate waste handling of this product. For more detailed information about recycling of this product, please contact your local council, your household waste disposal service or the shop where you purchased the product.

● The Symbol  mean: caution, risk of fire Oil-affected items can ignite spontaneously, especially when exposed to heat sources such as in a tumble dryer. The items become warm, causing an oxidation reaction in the oil. Oxidation creates heat. If the heat cannot escape, the items can become hot enough to catch fire. Piling, stacking or storing oilaffected items can prevent heat from escaping and so create a fire hazard. If it is unavoidable that fabrics that contain vegetable or cooking oil or have been contaminated by hair care products be placed in a tumble dryer they should first be washed in hot water with extra detergent - this will reduce, but not eliminate, the hazard.



## Ecological hints

To save energy and to help protect the environment, we recommend that you follow these hints:  
Try to load the maximum capacity of the machine as small loads are uneconomical.

- Do not over-dry laundry, this avoids creasing and saves energy.
- Select the drying program according to the type of laundry and the required degree of dryness.
- Clean the filters regularly to avoid excessive drying times and high electricity consumption.
- Ventilate the room well.

## **REPAIRS, SERVICE & WARRANTY**

It is hazardous for anyone installing, removing, altering, repairing, servicing or testing of this appliance.

Only an Authorised Service Person can carry out servicing or repairs to this appliance.

### **IF SERVICE IS REQUIRED:**

If you have a problem, and the problem persists after you have made the checks mentioned in this manual, contact:

TECO Australia's Service on 1300 660 037 (8:30am - 4pm Mon~Fri AEST) For warranty details please visit

[www.teco.com.au](http://www.teco.com.au)

Service Email : [had.service@teco.com.au](mailto:had.service@teco.com.au)

Spare Parts : [had.parts@teco.com.au](mailto:had.parts@teco.com.au)



# WARRANTY INFORMATION

Teco's warranty information for the product purchased is available at [www.teco.com.au](http://www.teco.com.au).

A copy of the warranty may also be obtained by contacting Teco's Warranty and Service Department on 1300 660 037 during business hours (Mon - Fri 8.30am - 4pm AEST).

To arrange for servicing of a Teco product, please contact our Warranty and Service Department on 1300 660 037 during business hours (Mon - Fri 8.30am - 4pm AEST).

To assist in processing any warranty claim that you may have Teco recommends that you:

1. Complete the following information in relation to your purchase:

Name of retailer: \_\_\_\_\_

Name of owner: \_\_\_\_\_

Date of purchase: \_\_\_\_\_

Model No. : \_\_\_\_\_

Serial No. : \_\_\_\_\_

MFG code: \_\_\_\_\_

2. Retain proof of your purchase for any warranty claim. Ideally this proof of purchase will be the tax invoice issued for your purchase.

3. Complete the following information in relation to the person that installed your Teco appliance (if applicable):

Installer's name: \_\_\_\_\_

Telephone No.: \_\_\_\_\_

Licence No.: \_\_\_\_\_

