

WASHING MACHINE

Front Load Washing Machine

User's Manual

Model:

TWM60FAS

TWM80FAS

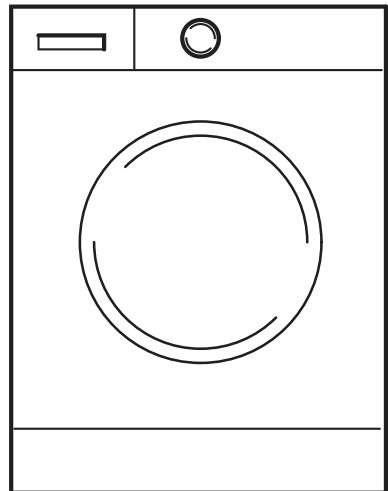

IMPORTANT NOTE:

Thank you for selecting a TECO quality Washing Machine. Read this manual carefully before installing or operating your new unit. Make sure to save this manual for future reference.

The design and specifications are subject to change without prior notice for product improvement. Consult with the sales agency or manufacturer for details.



CONTENTS

SAFETY INSTRUCTIONS	1
PRODUCT OVERVIEW	5
INSTALLATION	7
OPERATION	10
MAINTENANCE	16

SAFETY INSTRUCTIONS

Safety Instructions

For your safety, the information in this manual must be followed to minimize the risk of fire or explosion, electric shock, or to prevent property damage, personal injury or loss of life. Explanation of the symbols:

Warning!

This combination of symbol and signal word indicates a potentially dangerous situation which may result in death or serious injuries unless it's avoided.

Caution!

This combination of symbol and signal word indicates a potentially dangerous situation which may result in slight or minor injuries or damage to property and the environment.

Note!

This combination of symbol and signal word indicates a potentially dangerous situation which may result in slight or minor injuries.

SAFETY INSTRUCTIONS

To reduce risk of fire, electric shock or injury, always follow these basic precautions and accident prevention measures when using this appliance.

Electrical Safety

- **Voltage:** Plug the appliance to a 220-240V, 50Hz, properly earthed power outlet, it must be in good working order.
- **Power connection:** Do not use an adaptor, powerboard or an extension cord. Plug the power plug directly into a separate wall power point that cannot be accidentally turned off, and that is easily accessible so you can switch it off if needed.
- **Power cord:** Do not kink or damage the power supply cord. Make sure it is behind the appliance so no one can step on or place anything on the power supply cord or against it. A damaged power plug may overheat and cause a fire.
- **Damaged cord:** Do not use a cord that shows cracks or damage. Any damage to the cord may cause a short circuit, fire and/or electric shock.
- **Disconnection:** Never pull the power cord to unplug appliance. Grip the plug and pull it straight out from the power point.
- **Electrical work:** If the installation of this appliance requires any electrical work, make sure it is carried out by a licenced electrician.

Installation

- The product is heavy, be careful when moving it. To avoid back or other injury, have 2 people lift or mechanical aid when installing.
- When unboxing, thoroughly inspect the appliance carefully for any damage. If there is any damage, do not install the appliance.
- While installing the appliance make sure that the power cord is not bent or flattened.
- Make sure to remove all packaging materials such as foams and tapes.
- **Remove all the transit bolts (x 4) at the back of the machine before installing the appliance.**
- It isn't intended to be enclosed or built-in to a cabinet.
- The openings must not be obstructed by a carpet.
- Install the washing machine on a flat level and stable ground.

SAFETY INSTRUCTIONS

Usage Conditions and Restrictions

- This appliance is not intended for use by persons (including children) with reduced physical, sensory or mental capabilities or lack of experience and knowledge unless they have been given supervision or instruction concerning use of the appliance by a person responsible for their safety.
- Children should be supervised to ensure that they do not play with appliance.
- Animals and children may climb into the machine, therefore check the machine before every operation.
- Machine may become very hot during operation. Keep kids and pets far away from the machine as possible during operation.
- It is intended for indoor domestic use only. It is not to be used for industrial or commercial purposes.
- Do not use this product for anything other than its intended purpose, and only use it as described in this manual. Do not attempt to alter or modify this appliance.
- **In the process of a hot wash, the glass door can become hot. Make sure not to touch it or that no children or pets come into contact with the door.**
- Flammable and explosive or toxic solvents are forbidden. Gasoline and alcohol etc. shall not be used as detergents. Please only select the detergents suitable for washing machines, especially for drums.
- Do not wash or dry articles that have been cleaned in, washed in, soaked in, or dabbed with combustible or explosive substances (such as wax, oil, paint, gasoline, degreasers, dry-cleaning solvents, kerosene, etc.) This may result in fire or explosion.
- **Ensure that all pockets are emptied of every item to make sure that there are no hard, sharp objects such as coins, safety pins, bra wires, nails or screws which can cause damage to the appliance and will block the drain pump.**

SAFETY INSTRUCTIONS

- Damage or malfunction caused from foreign objects is not covered by your warranty to the appliance.
- Incorrect use can result in property damage, injury or death. We accept no liability for the misuse of this appliance or noncompliance with these instructions.
- This appliance is intended to be used in household and similar applications such as:
 - staff kitchen areas in shops, offices and other working environments;
 - domestic residences;
 - by clients in hotels, motels and other residential type environments;
 - bed and breakfast type environments;
 - areas for communal use in blocks of flats.

Cleaning and Maintenance

- Before cleaning or maintenance, always unplug the appliance from the power socket. Make sure you pull by the plug, not the cord as this can damage the power cord and cause a hazard.
- Only the filter requires regular cleaning, everything else are non user-serviceable parts. Do not try to repair, disassemble or modify the appliance.
- Check and clean the lint filter on a regular basis.
- Service: Never try to repair, modify or replace any part of the appliance. All servicing is to be done by a qualified & licenced technician.

Disposal

- Contact your local authorities for correct method of disposal. Dispose of all packaging in a responsible manner in accordance with local regulations.
- Dispose of old appliances in accordance with local regulations. Remove the doors, cut off the main cable, break or remove spring or bolt catches if fixed to prevent children getting trapped or involve themselves in other dangers.



PRODUCT OVERVIEW

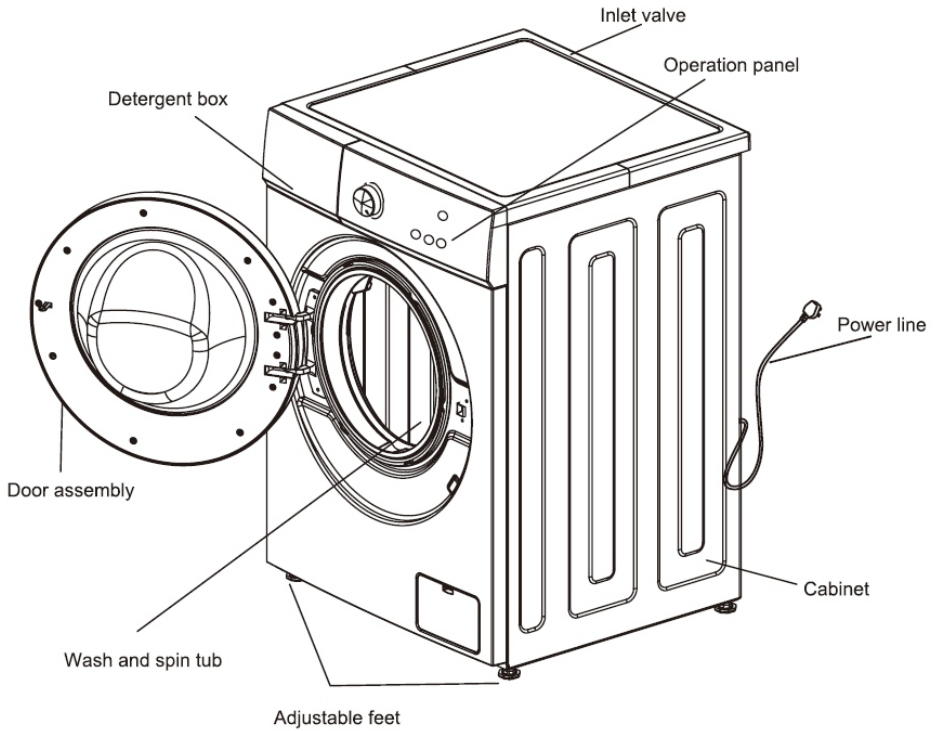

Accessories

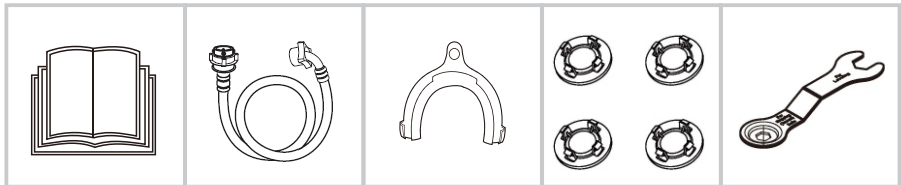

Users manual

Inlet hose
(cold water)

Drain hose
Support

Transportation
bolt caps

Spanner

Note!

- Illustrations in this manual are for explanatory purposes only. Please refer to the product for actual images.

PRODUCT OVERVIEW

Control Panel

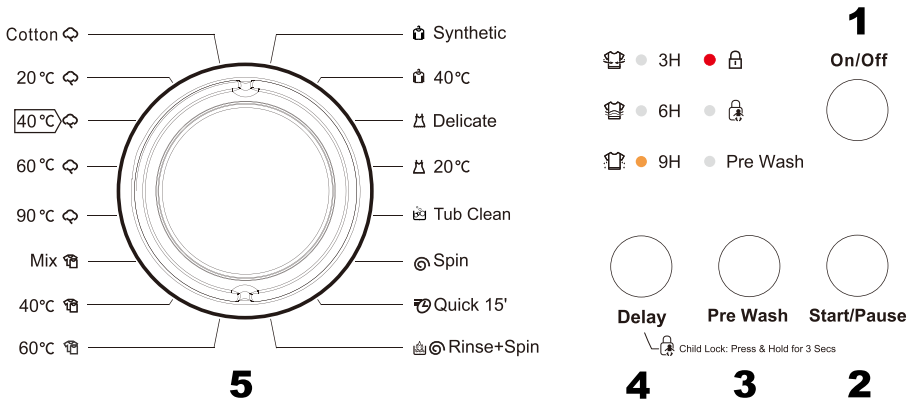

1. ON/OFF

2. START/PAUSE

3. PRE WASH

If clothes are very dirty, select this function as an additional before washing.

4. DELAY

When using Delay, you can delay washing for up to 18 hours.

3H. 6H. 9H. 12H (3H + 9H Indicator). **15H** (6H + 9H Indicator).

18H (3H + 6H + 9H indicator).

CHILD LOCK

Press and hold **Delay** for 3 seconds to activate child lock, follow same sequence to unlock.

5. WASH PROGRAM DIAL

Status Indicator



Indicates **WASH** status



Indicates **DOOR LOCK** state



Indicates **RINSE** status



Indicates **CHILD LOCK** state



Indicates **SPIN** status

INSTALLATION

⚠ Warning!

Before installing your appliance, read all safety instructions in this manual, especially the sections on electrical safety and installation.

Installation Area

Before installing the machine, the location with following characteristics shall be selected.

- Rigid, dry, and level surface.
- Avoid direct sunlight.
- Sufficient ventilation.
- Room temperature is above 0°C.
- Keep far away from heat resources such as wood or gas heaters

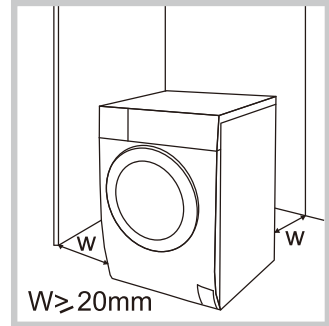

Unpacking

Remove all the packing (including the foam base), otherwise vibration and noise may occur during wash.

⚠ Warning!

- Packaging material (e.g. Films, Styrofoam) can be dangerous for children. There is a risk of suffocation ! Keep all packaging well away from children.
- **VERY HEAVY!** Be sure mechanical aid is required when moving the appliance.

Remove Transport Bolts

⚠ Caution!

- **IMPORTANT!** Make sure to remove the transit bolt from the back of the appliance and cover the holes with the hole covers provided.
- Leaving the bolts in can result in the machine being unstable and move, cause vibration and malfunction.

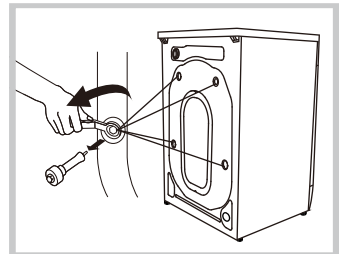

INSTALLATION

Levelling the Washing Machine

- Using a spirit level is recommended
1. Check if the legs are closely attached to the cabinet. If not, please turn them to their original positions tighten the nuts.
 2. Loosen the lock nut turn the feet until it closely contacts with the floor.
 3. Adjust the legs and lock them with a spanner, make sure the machine is steady and level.

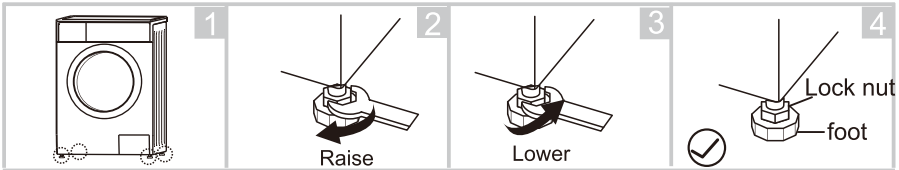

Connecting the Water Inlet Hose

⚠ Warning!

- Do not kink, crush, modify or sever water inlet hose.
- Water Pressure: Minimum 0.03MPa, Maximum 1MPa.
- Be sure to install the inlet hose to **COLD WATER** only! Incorrect installation can affect the performance or damage the clothes washer.
- Ensure there is a rubber washer inside the hose before fastening. The washer prevents water leakage.

1. Connect the elbow to tap and fasten it clockwise.
2. Connect the other end of inlet hose to the inlet valve at the back of washing machine and fasten the pipe tightly clockwise.

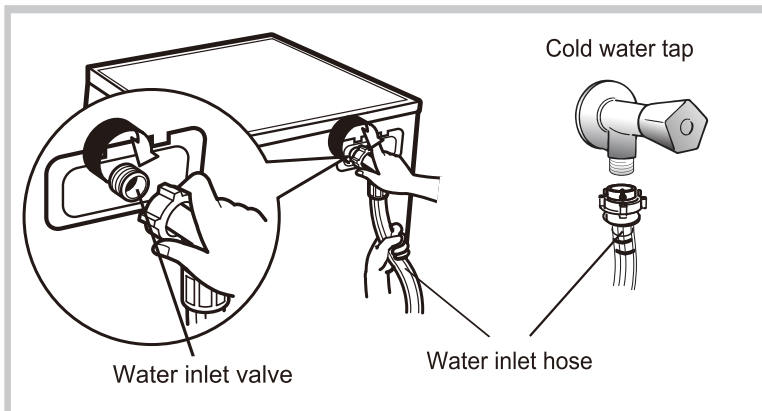

INSTALLATION

Placing the Drain Hose

Warning!

- Do not kink, crush or protract the drain hose.
- Position the drain hose properly, otherwise damage might result of water leakage.
- If the drain hose is too long, do not force it into washing machine as it will cause abnormal noises.

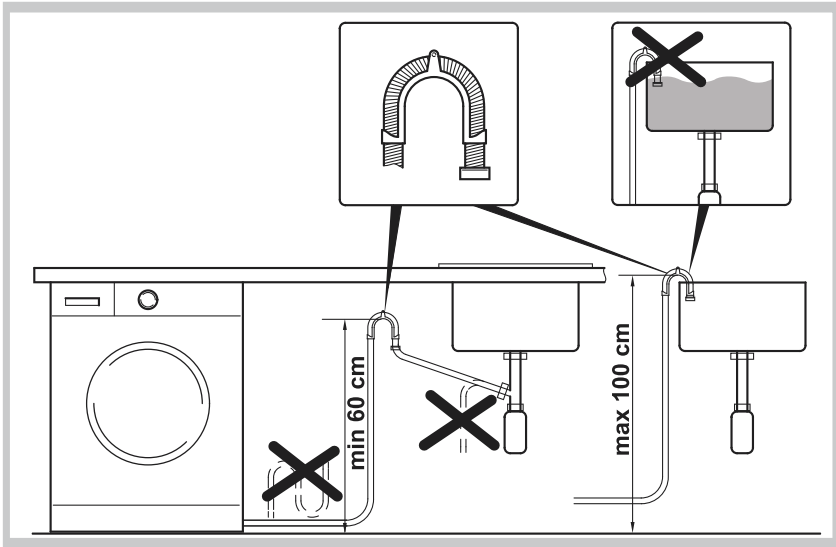

OPERATION

Quick Start

1. Before Washing

⚠ Caution!

- Before the first wash make sure everything is installed correctly.
- Make sure to do one wash with no items inside to clean out the hoses and drum before your first loaded wash.

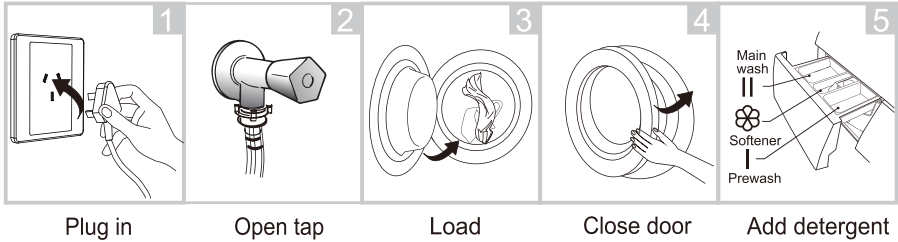

2. Washing

After the above steps have been completed, in a few simple steps shown below you can select the type of wash you want and get started.

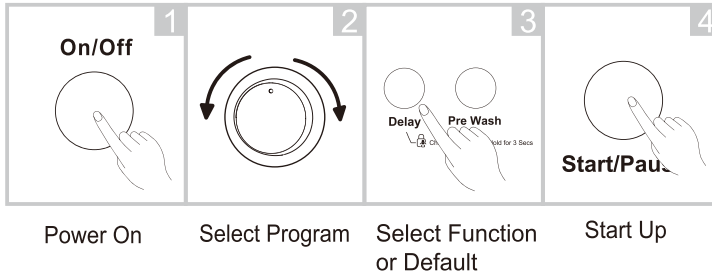

📌 Note!

- If default is selected, step 3 can be skipped.

3. After Washing

Buzzer beep or “End” flash on display.

OPERATION

Before Each Washing

- The washer should be used in an ambient temperature range of (0-40)°C. If used below 0°C, the inlet valve and draining system may be damaged. If the machine is used below 0°C, then it should be moved to normal ambient temperature conditions to ensure the water supply hose and drain hose are not frozen before use.
- Please check the labels and the explanation of using detergent before wash.
- Use non-foaming or less-foaming detergent suitable for machine washing only.

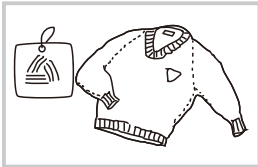

Check the label



Take out the items out of the pockets

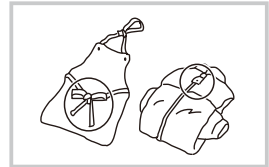

Knot the long strips,zip or button

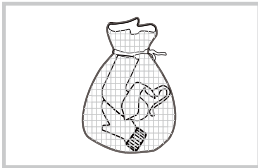

Put small clothes into the pillow slip

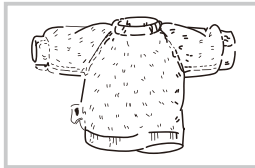

Turn easy-pilling and long-pile fabric inside out

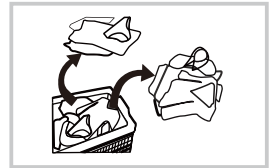

Separate clothes with different textures

⚠ Warning!

- When washing single clothing, it may cause an unbalanced situation when washing or in spin cycle. Therefore it is suggested to add one or two more clothes to be washed together so that the program cycle is well balanced.
- Don't wash clothes touching with kerosene, gasoline, alcohol and other flammable materials.

OPERATION

Wash Care Symbols

When choosing a wash program, check for any labels on your clothes and follow the instructions. Below are some commonly used symbols.

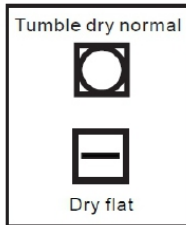
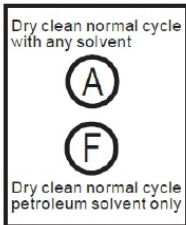
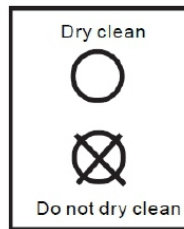
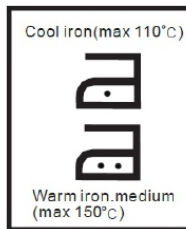
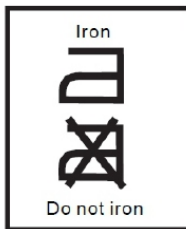
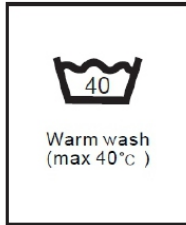

OPERATION

Detergent Dispenser

Note!

- Only use low-subsiding detergents and clothing care preparations that are for use in a front load washing machine.
- Follow the instructions on the detergent package.

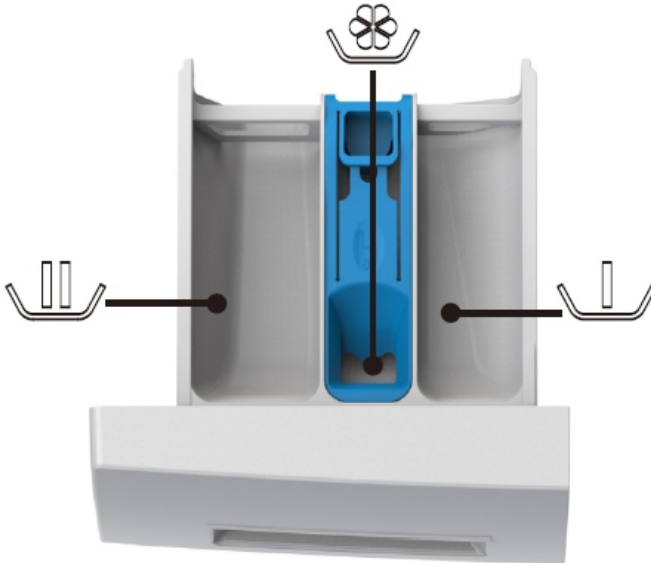

Pre Wash Detergent



Main Wash Detergent



Softener

- Place fabric softener into this compartment.
- Make sure not to exceed MAX level.

OPERATION

Program Table

Model: TWM60FAS

program	temperature (°C)	rinse (times)	time (m)	revolution (rpm)	maximum load	Cloth type
Cotton	Cold	2	88	1000	rated	general cotton fabrics
20°C	20	2	93	1000		
 40°C	40	2	337	1200		
60°C	60	2	295	1200		
90°C	90	2	149	1000		
Mix	Cold	2	66	1000	≤4kg	cotton fabrics/ cellulose comdound
40°C	40	2	78	1000		
60°C	60	2	95	1000		
Synthetic	Cold	2	61	1000	≤3kg	cellulose compound
40°C	40	2	73	1000		
Delicate	Cold	2	56	1000	≤3kg	Gauze/Silk Fabric
20°C	20	2	59	1000		
Tub Clean	60	2	78	800	—	Normal (Intensive, Time Save)
Spin	—	—	14	1000	rated	cotton fabrics/cellulose comdound
Quick 15'	Cold	2	15	1000	≤2kg	not too dirty and frequently used clothes
Rinse+Spin	Cold	2	34	1000	rated	cotton fabrics/ cellulose compound

- Energy test program: Cotton 40°C.
- Cotton 40°C is the standard washing program to which the information in the label and the product information sheet relates, and they are suitable to clean normally soiled cotton laundry and that they are the most efficient programs in terms of combined energy and water consumptions for washing that type of cotton laundry, that the actual water temperature may differ from the illustrated cycle temperature.

Note!

- **The parameters in this table are only for user's reference.**
- **The program time will be vary according to the water pressure, cloths variety, wash load, water temperature, spin cycle, etc.**

OPERATION

Model: TWM80FAS

program	temperature (°C)	rinse (times)	time (m)	revolution (rpm)	maximum load	Cloth type
Cotton	Cold	2	88	1000	rated	general cotton fabrics
20°C	20	2	93	1000		
40°C	40	2	352	1200		
60°C	60	2	121	1200		
90°C	90	2	149	1000		
Mix	Cold	2	66	800	≤ 6kg	cotton fabrics/ cellulose compound
40°C	40	2	78	800		
60°C	60	2	95	800		
Synthetic	Cold	2	61	1000	≤ 4kg	cellulose compound
40°C	40	2	73	1000		
Delicate	Cold	2	56	800	≤ 4kg	Gauze/Silk Fabric
20°C	20	2	59	800		
Tub Clean	60	2	78	800	—	Normal (Intensive, Time Save)
Spin	—	—	14	1000	rated	cotton fabrics/cellulose compound
Quick 15'	Cold	2	15	1000	≤ 3kg	not too dirty and frequently used clothes
Rinse+Spin	Cold	2	34	1000	rated	cotton fabrics/ cellulose compound

- Energy test program: Cotton 40°C.
- Cotton 40°C is the standard washing program to which the information in the label and the product information sheet relates, and they are suitable to clean normally soiled cotton laundry and that they are the most efficient programs in terms of combined energy and water consumptions for washing that type of cotton laundry, that the actual water temperature may differ from the illustrated cycle temperature.

Note!

- The program time in this table are for the user's reference only
- The actual time will vary according to the water pressure, cloths variety, wash load, water temperature selected, spin cycle, etc.

MAINTENANCE

Cleaning And Care

Warning!

- Before starting maintenance, ensure that the appliance is unplugged and the water tap is turned off.

Cleaning The Cabinet

Proper maintenance on the washing machine can extend its working life. The surface can be cleaned with diluted non-abrasive neutral detergents when necessary. If there is any water overflow, use the wet cloth to wipe it off immediately. Make sure no sharp items are used to clean the appliance.

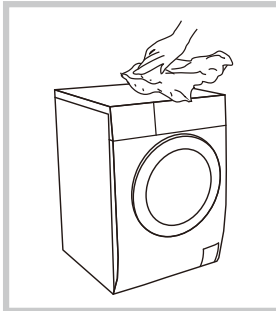

Note!

Formic acid and its diluted solvents or equivalent are forbidden, such as alcohol, solvents or chemical products, etc.

Cleaning The Door Seal And Glass

Wipe the glass and seal after each wash to remove lint and stains. If lint builds up it can eventually cause leaks. Remove any coins, buttons and other objects from the seal (if any) after each wash.

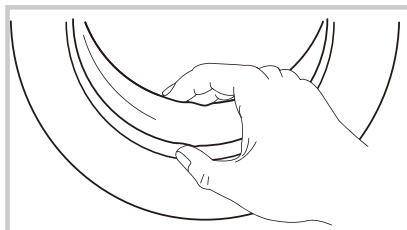

MAINTENANCE

Cleaning the Inlet Filter

Note!

- Inlet filter must be cleaned if there is low water pressure.

Washing the filter in the hose

1. Close the tap.
2. Unscrew the water supply hose from the tap.
3. Clean the filter.
4. Reconnect the water supply hose.

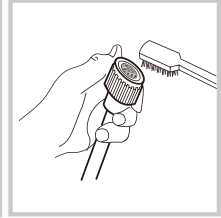
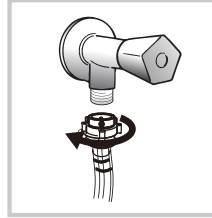

Washing the filter in washing machine

1. Unscrew the inlet hose from the back of the machine.
2. Pull out the filter with long nose pliers and reinstall it back after being washed.
3. Use a brush to clean the filter
4. Reconnect the inlet hose and turn on the tap.

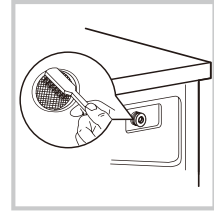
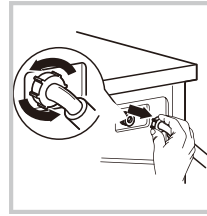

Cleaning the Detergent Dispenser

1. Press down the arrow location on softener cover inside the dispenser drawer.
2. Lift the clip up and take out softener cover and wash all grooves with water.
3. Restore the softener cover and push the drawer into position.

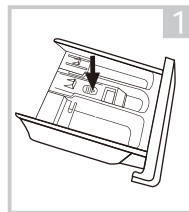

Pull out the dispenser drawer with press the A

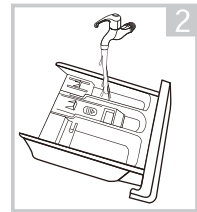

Clean the dispenser drawer under water

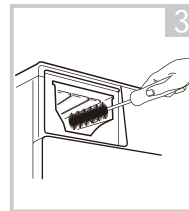

Clean inside the recess with an old toothbrush

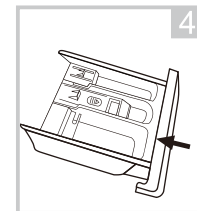

Insert the dispenser drawer

Note!

- Do not use alcohol, solvents or chemical products to clean the machine.

MAINTENANCE

Cleaning The Drain Pump Filter

⚠ Warning!

- Unplug the machine to avoid electrical shock before cleaning.
- Be careful of the hot water!
- When the appliance is in use and depending on the program selected there can be hot water in the pump. Never remove the pump cover during a wash cycle, always wait until the appliance has finished the cycle, and is empty.
- Never remove the filter during a wash cycle. Always wait until the appliance has finished the cycle and is empty.

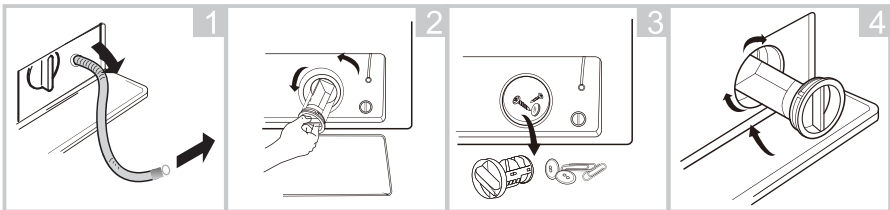

1
Open the filter cover.
Pull out the emergency
drain hose, remove the
valve cap and drain the
water into a container.

2
Unscrew and
remove the filter by
turning it counter
clockwise.

3
Remove foreign
matter and clean the
filter carefully.

4
Put the filter back by
turning it clockwise
and close the
service flap.

⚠ Caution!

- Make sure that valve cap and emergency drain hose are reinstalled properly, cap plates should be inserted aligning to hole plates otherwise water may leak.
- Some machines don't have emergency drain hose, rotate lower cover cap directly to make water run into basin.
- Drain pump filter can filter the lint and foreign matters (coins, buttons etc.) from the washing.
- Clean the filter periodically to ensure the normal operation of washing machine.
- When replacing the cover, ensure it is securely re-tightened.

MAINTENANCE

Troubleshooting

Should your appliance fail to work or it stops during operation. First try to find a solution to the problem, if not, contact the service centre.

Description	Possible Cause	Solution
Washing machine is not starting	<ul style="list-style-type: none">• Plug is not in the socket.• Not switched On.• Power failure.• Door is not closed properly.	<ul style="list-style-type: none">• Plug in.• Switch On.• Check the power.• Close the door. Check if the clothes is stuck.
Door will not open	<ul style="list-style-type: none">• 2 minutes have not elapsed since the program finished.• Washer's safety protection is active.	<ul style="list-style-type: none">• Wait a few minutes.• Disconnect the power and restart the appliance.
Water leakage	<ul style="list-style-type: none">• Leaking between tap and water inlet hose.• Drain is blocked.• Detergent dispenser blocked.	<ul style="list-style-type: none">• Tighten the inlet hose.• Clean the hose filter.• Replace the inlet hose.• Clean the drain.• Clean the dispenser.
Does not fill with water	<ul style="list-style-type: none">• Tap turned Off.• Not switched On.• Water inlet hose kinked.• Water inlet hose blocked.	<ul style="list-style-type: none">• Turn on the tap.• Switch On• Straighten the inlet hose.• Clean the inlet hose filter.
Vibrates	<ul style="list-style-type: none">• Transit bolts not removed.• Machine is not leveled.• Load not distributed evenly.	<ul style="list-style-type: none">• Remove the transit bolts.• Adjust the adjustable feet to level the machine.• Rearrange the laundry evenly.
Abnormal noise	<ul style="list-style-type: none">• Transit bolts not removed.• Did not remove all packages materials.• Machine is not leveled.	<ul style="list-style-type: none">• Remove the transit bolts.• Remove all package materials.• Adjust the adjustable feet to level the machine.



Note!

- It is normal the machine makes different noises when spinning because it has a brush motor for better performance.

MAINTENANCE

Repairs, Service & Warranty

It is hazardous for anyone installing, removing, altering, repairing, servicing or testing of this appliance.

Only an Authorised Service Person can carry out servicing or repairs to this appliance.

IF SERVICE IS REQUIRED:

If you have a problem, and the problem persists after you have made the checked mentioned in this manual, contact:

TECO Australia's Service on 1300 660 037 (8:30am - 4pm Mon-Friday AEST).

For warranty details please visit www.teco.com.au

Service email: had.service@teco.com.au

Spare parts: had.parts@teco.com.au

Did you know?

TECO Australia's product range also includes:

- Top Load Clothes Washers
- Front Load Clothes Washers
- Auto Sensing Vented Clothes Dryers
- Refrigerators
- Chest and Vertical Freezers
- Bar Fridges
- Televisions
- Air Curtains
- Air Conditioners

Visit **www.teco.com.au** for our full range.



WARRANTY INFORMATION

Teco's warranty information for the product purchased is available at www.teco.com.au.

A copy of the warranty may also be obtained by contacting Teco's Warranty and Service Department on 1300 660 037 during business hours (Mon - Fri 8.30am - 4pm AEST).

To arrange for servicing of a Teco product, please contact our Warranty and Service Department on 1300660 037 during business hours (Mon - Fri 8.30am - 4pm AEST).

To assist in processing any warranty claim that you may have Teco recommends that you:

1. Complete the following information in relation to your purchase:

Name of retailer: _____

Name of owner: _____

Date of purchase: _____

Model No. : _____

Serial No. : _____

MFG code: _____

2. Retain proof of your purchase for any warranty claim. Ideally this proof of purchase will be the tax invoice issued for your purchase.
3. Complete the following information in relation to the person that installed your Teco appliance (if applicable):

Installer's name: _____

Telephone No.: _____

Licence No.: _____

