

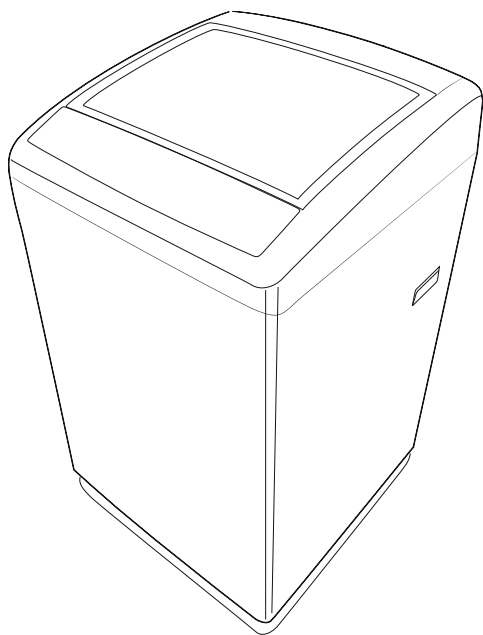

WASHING MACHINE

User's Manual



Model:

TWM55TCM

TWM70TCM

TWM100TCM

IMPORTANT NOTE:

Thank you for selecting a TECO quality Washing Machine. Read this manual carefully before installing or operating your new unit. Make sure to save this manual for future reference.

The design and specifications are subject to change without prior notice for product improvement. Consult with the sales agency or manufacturer for details.



CONTENTS

SAFETY INSTRUCTIONS

■ Safety Instructions	2
-----------------------------	---

INSTALLATION

■ Product Description	7
■ Installation Area	8
■ Unpacking the Washing Machine	8
■ Installing the Base Cover (Option)	8
■ Installing the Drain Hose	9
■ Levelling the Washing Machine	9
■ Installing the Water Inlet Hose	10

OPERATIONS

■ Preparation Before Washing	11
■ Washing	11
■ After Washing	11
■ Loading	12
■ Detergent	12
■ Control Panel	13
■ Options	14
■ Personalized Setting of Washing Program.....	15
■ Operations of Washing Process	15
■ Washing Programmes Table	16

Maintenances

■ Cleaning And Care	17
■ Cleaning the Cabinet	17
■ Cleaning the Inlet Filter	17
■ Cleaning Drain Pump Filter	18
■ Trouble Shooting	19
■ Technical Specifications	20
■ Repairs, Service & Warranty	23

SAFETY INSTRUCTIONS

■ Safety Instructions

For your safety, the information in this manual must be followed to minimize the risk of fire or explosion, electric shock, or to prevent property damage, personal injury or loss of life.

Explanation of the symbols:



Warning!

This combination of symbol and signal word indicates a potentially dangerous situation which may result in death or serious injuries unless it's avoided.



Caution!

This combination of symbol and signal word indicates a potentially dangerous situation which may result in slight or minor injuries or damage to property and the environment.



Note!

This combination of symbol and signal word indicates a potentially dangerous situation which may result in slight or minor injuries.



Warning!

The electric shock!

- If the supply cord is damaged, it must be replaced by the manufacturer, its service agent or similarly qualified persons in order to avoid a hazard.
- The openings must not be obstructed by a carpet.
- This appliance is for indoor use only.
- Do not put washing machine at humid place.

SAFETY INSTRUCTIONS

- Hands shall not be inserted into running spin-dry tub .
- If the spin-dry tub does not stop within 15 seconds after opening the cover , please stop using the machine and have it repaired.
- The new hose-sets supplied with the appliance are to be used and that old hose-sets should not be reused.
- Before any maintenance the device, unplug the appliance from the mains.
- Always unplug the machine and turn off the water supply after use. The max. inlet water pressure, in pascals. The min. inlet water pressure, in pascals.
- To ensure your safety, power plug must be inserted into an earthed three-pole socket. Check carefully and make sure that your socket is properly and reliably earthed.
- Make sure that the water and electrical devices must be connected by a qualified technician in accordance with the manufacturer's instructions and local safety regulations.

Risk to children!

- This appliance is not intended for use by persons (including children) with reduced physical, sensory or mental capabilities or lack of experience and knowledge unless they have been given supervision or instruction concerning use of the appliance by a person responsible for their safety.
- Children should be supervised to ensure that they do not play with appliance.
- Animals and children may climb into the machine. Check the machine before every operation.

SAFETY INSTRUCTIONS

- Machine may be very hot during the operation. Keep kids and pets far away from the machine during the operation.
- Remove all packages before using the appliance. Otherwise, serious damage may result.
- The washing machine with single inlet valve only can be connected to the cold water supply. The product with double inlet valves should be correctly connected to the hot water and cold water supply.
- Plug must be accessible after installation.

Risk of explosion!

- Do not wash or dry articles that have been cleaned in, washed in, soaked in, or dabbed with combustible or explosive substances (such as wax, oil, paint, gasoline, degreasers, dry-cleaning solvents, kerosene, etc.) This may result in fire or explosion.
- Before hand thoroughly rinse items of washing by hand.



Caution

Installing the product!

- This washing machine is for indoor use only.
- It isn't intended to be built-in using.
- The openings must not be obstructed by a carpet.
- Washing machine shall not be installed in bath room or very wet rooms as well as in the rooms with explosive or caustic gases.

SAFETY INSTRUCTIONS

- Remove all packages and transport bolts before using the appliance. Otherwise, serious damage may result.
- The washing machine with single inlet valve only can be connected to the cold water supply. The product with double inlet valves should be correctly connected to the hot water and cold water supply.
- Plug must be accessible after installation.

Risk of damaging appliance!

- Your product is only for home use and is only designed for the textiles suitable for machine washing.
- Do not climb up and sit on top cover of the machine.
- Do not lean against machine door.
- Cautions during Handling Machine:
 1. Transport bolts shall be reinstalled to the machine by a specialized person.
 2. The accumulated water shall be drained out of the machine.
 3. Handle the machine carefully. Never hold each protruded part on the machine while lifting. Machine door can not be used as the handle during the conveyance.
 4. This appliance is heavy. Transport with care.
- Please do not close the door with excessive forces.
- It is forbidden to wash carpets.

SAFETY INSTRUCTIONS

Operating the appliance!

- Before washing the clothes at first time, the product shall be operated in one round of the whole procedures without the clothes inside.
- Flammable and explosive or toxic solvents are forbidden. Gasoline and alcohol etc. Shall not be used as detergents. Please only select the detergents suitable for machine washing, especially for drum.
- Make sure that all pockets are emptied. Sharp and rigid items such as coin, brooch, nail, screw or stone etc. may cause serious damages to this machine.
- Please check whether the water inside the drum has been drained before opening its door. Please do not open the door if there is any water visible.
- Be careful of burning when the product drains hot washing water.
- Never refill the water by hand during washing.
- After the program is completed. Please wait for two minutes to open the door.

Packaging/Old appliance



- Contact your local authorities for correct method of disposal. Dispose of all packaging in a responsible manner in accordance with local regulations.
- Dispose of old appliances in accordance with local regulations. Remove the doors, cut off the main cable, break or remove spring or bolt catches if fixed to prevent children getting trapped or involve themselves in other dangers.

INSTALLATION

■ Product Description

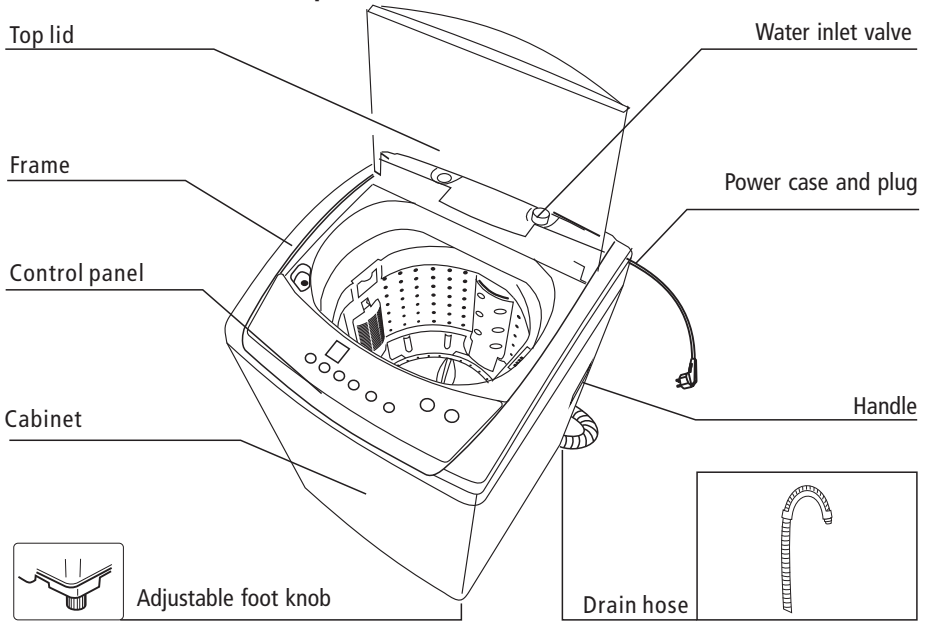

📌 Note!

- The product line chart is for reference only, please refer to real product as standard.

Accessories

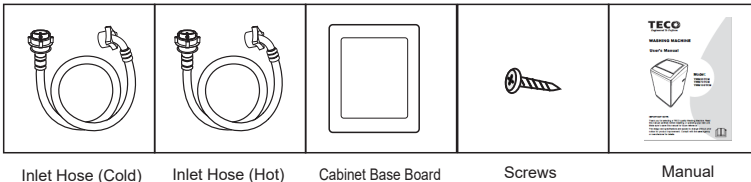

📌 Note!

- Note: if the drain hose is already installed on the machine, then there is no spring clammer and drain hose in the accessories.

INSTALLATION

■ Installation Area

⚠ Warning!

- Stability is important to prevent the product from wandering!
- Make sure that the product is not sitting on the power cord.

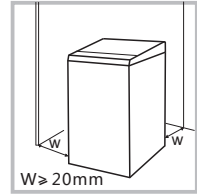

Before installing the machine, the location characterized as follows shall be selected:

1. Rigid, dry, and level surface
2. Avoid direct sunlight
3. Sufficient ventilation
4. Room temperature is above 0 °C
5. Keep far away from the heat resources such as coal or gas.

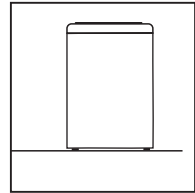

■ Unpacking the Washing Machine

⚠ Warning!

- Packaging material (e.g. Films, Styrofoam) can be dangerous for children.
- There is a risk of suffocation ! Keep all packaging well away from children.

1. Remove the cardboard box and styrofoam packing.
2. Lift the washing machine and remove the base packing.
3. Remove the tape securing the power supply cord and drain hose.
4. Remove the inlet hose from the drum.

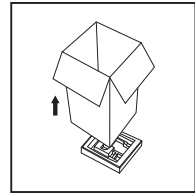

■ Installing the Base Cover (Option)

⚠ Warning!

- Make sure the power cord is unplugged from the mains supply.
- Assistant required for lifting.

1. Tilt or gently lay the washing machine on some soft padding (such as a soft mat, blanket or thick towel) on its back.
2. Insert the base cover into the grooves on the underside of the washing machine. (As shown in the figure).
3. Secure the base cover accordingly with screws supplied.

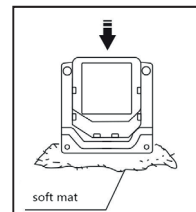

INSTALLATION

■ Installing the Drain Hose

1. Completely slide the drain hose over the drainage spout.
2. Fix and tighten it with a hoop. (As shown in the figure).

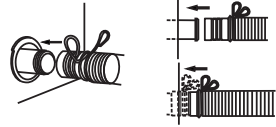

⚠ Caution!

- The drain hose may already be installed on the machine.
- Do not kink or protract the drain hose.
- Position drain hose properly, otherwise damage might result of water leakage.
- If drain hose is too long, do not force it into washing machine as it will cause abnormal noises.

There are two ways to place the end of drain hose:

1. For lower drain system

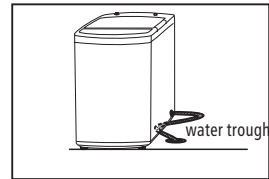
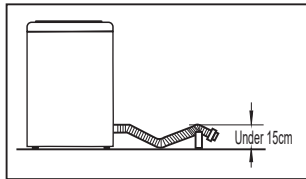
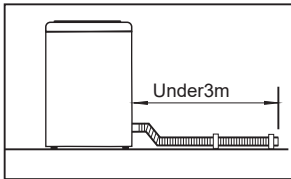

2. For upper drain system

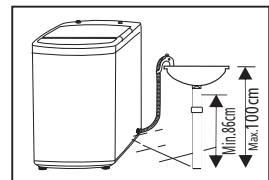
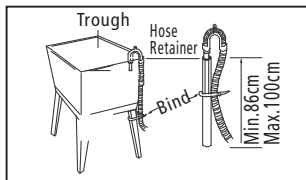
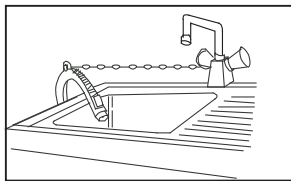

■ Levelling the Washing Machine

⚠ Caution!

- The lock nuts on all four feet must be screwed tightly against the housing.

1. Check if the legs are closely attached to the cabinet. If not, please turn them to their original positions tighten the nuts.
2. Check alignment of the product with a spirit level and if required, correct.
3. Loosen the lock nut and turn the feet until it closely contacts with the floor.
4. After being locked properly, press four corners again to make sure that they **have** been adjusted properly.

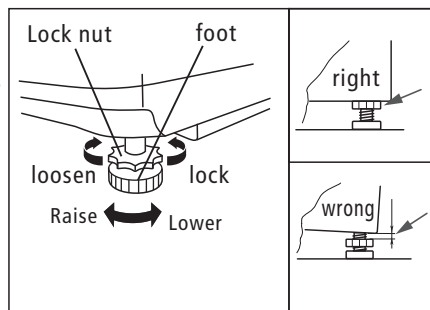

INSTALLATION

■ Installing the Water Inlet Hose

1. Fasten one end of the inlet hose to the tap. Ensure there is a rubber washer inside the hose before fastening. The washer prevents water leakage.
2. Securely tighten the other end of the inlet hose to the clothes washer inlet valve. Ensure the rubber washer is inside the hose before tightening.
3. When tightening the clamping nut, apply even pressure. Do not apply too much force or twist the valve as this may damage or break the valve joint.

⚠ Caution!

- Be sure to install the correct HOT and COLD water inlet hoses. Incorrect installation can reduce performance or damage the clothes washer.

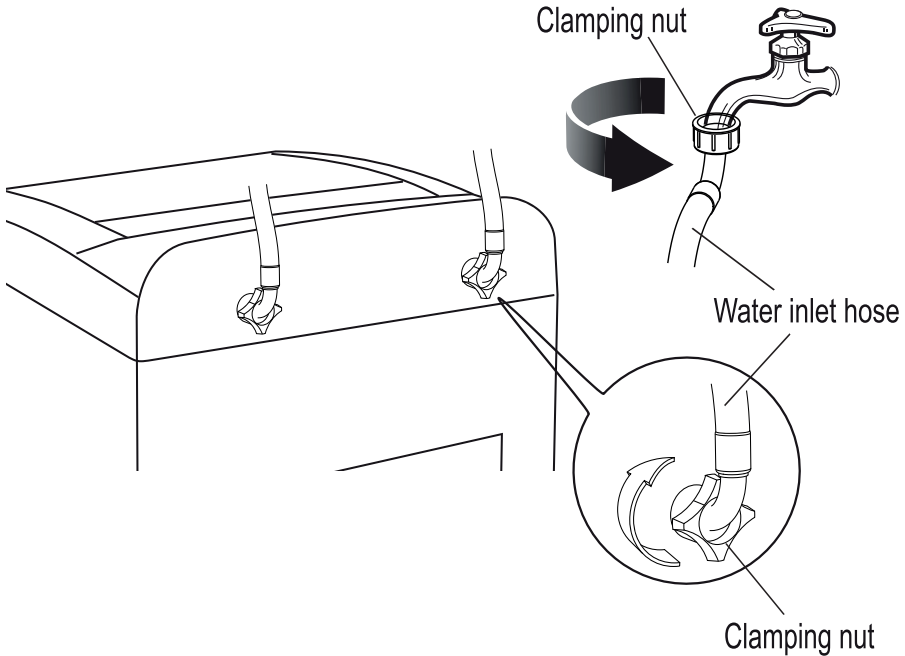

⚠ Caution!

- To prevent leakage or water damage, follow the instructions in this chapter!
- Do not kink, crush, modify or sever water inlet hose.

OPERATIONS

■ Preparation Before Washing

⚠ Caution!

- Before washing, please make sure it's installed properly.
- Before washing it at first time, the washing machine shall be operated in one round of the whole procedures without clothes in as follows.

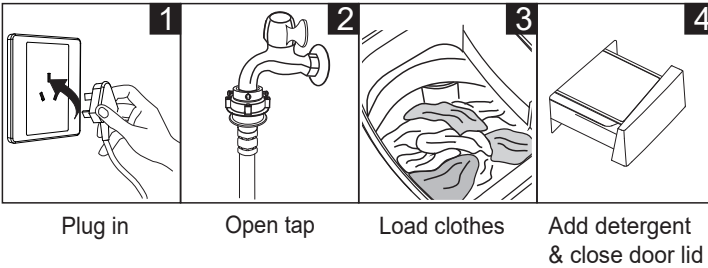

■ Washing

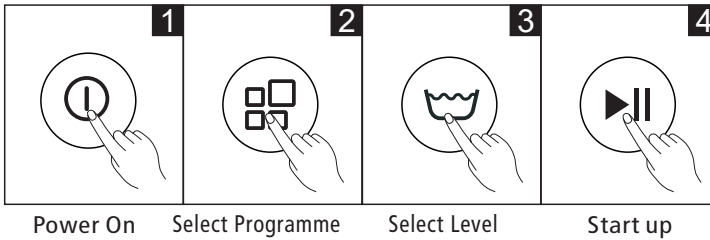

📌 Note!

- If default is selected, step 2, 3 can be skipped.

■ After Washing

Buzzer will beep after washing finished and the power supply will be cut off automatically. Then unload the laundry.

OPERATIONS

■ Loading

- The working condition of the washer should be (0-40)°C. If used under 0°C, the inlet valve and draining system may be damaged. If the machine is placed under condition of 0°C or less, then it should be transferred to normal ambient temperature to ensure the water supply hose and drain hose are not frozen before use.
- Please check the labels and the explanation of using detergent before wash. Use non-foaming or less-foaming detergent suitable for machine washing properly.

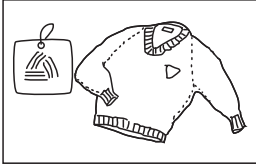

Check the label for recommended wash options

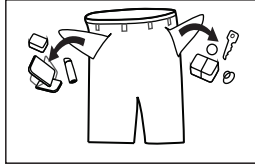

Take out any items left in the pockets

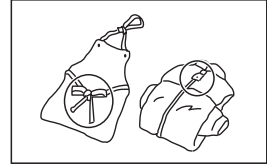

Knot ribbons, cords to protect from possible damage

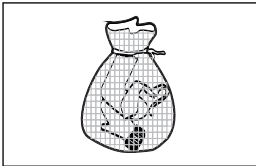

Put small clothes into the pillow slip

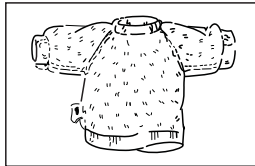

Turn clothes inside out to prevent pilling

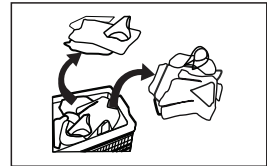

Separate clothes with different textures

⚠ Warning!

- When washing single clothing, it may cause alarm to be sounded due to causing an unbalanced situation when in spin cycle. Therefore it is suggested to add one or two more clothes to be washed together so that the spin cycle is well balanced.
- Don't wash clothing soaked with kerosene, gasoline, alcohol and other flammable materials.

■ Detergent

- Using liquid or powdered detergent.
- Follow the instructions on the detergent package.
- For detergents **that** are not dissolving well, it is suggested to use warm water for dilution to prevent the inlet of detergent box from being blocked and overflowing while filling water. Please choose suitable type of detergent for the various washing temperature to get the best washing performance with less water and energy consumption.

OPERATIONS

Control Panel

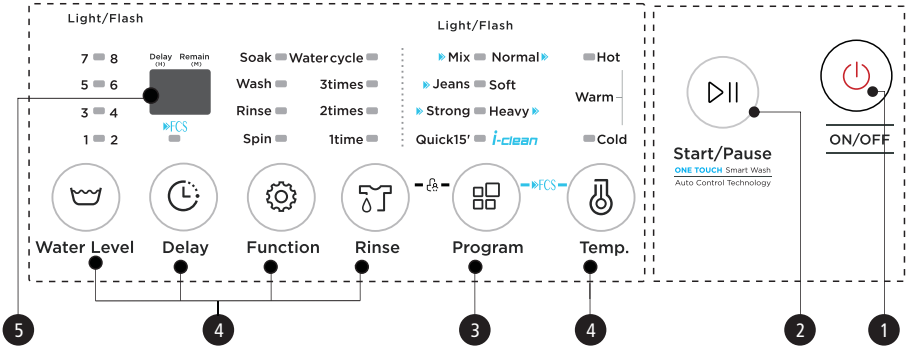

Note!

- The chart is for reference only, Please refer to real product as standard.

1 On/Off

Product is switched on or off.

2 Start/Pause

Press the button to start or pause the washing cycle.

3 Programmes

Available according to the laundry type.

4 Option

This allows you to select an additional function and will light when selected.

5 Display

The display shows the settings, estimated time remaining, options, and status messages for your washer. The display will remain on through the cycle.

When LED lighting, it means the time that delay to start the machine.

When LED lighting constant, it means the program time that remaining.

OPERATIONS

Options

Only for washers having these function.



Water Level

Water level

select water level according to clothing categories, degree of soiling and washing habits of customers



Rinse

Rinse

rinsing times settings can be selectable



Function

Function

combination of soaking, washing, rinsing and spinning light is available



Temp.

Temp.

Press the button to regulate the Hot, warm, cold water for wash.



Delay

Delay

1. Select a program
2. Press the Delay button to choose the time
3. Press [Start/Pause] to commence the delay operation



On



Choose the Program



Setting time



Start

Press the [Delay] button until the Delay light is off . It should be pressed before starting the program. If the program already started, should press the [On/Off] button to reset the program.

⚠ Caution!

- If there is any break in the power supply while the machine is operating, a special memory stores the selected program and when the power is restarted .



FCS



ON/OFF



FCS



Start



The FCS light

(Press both Program and Temp. button together)



Child Lock

Child Lock

To avoid mis operation by children.



Power on



Start



Press Child Lock

(Press both Rinse and Program button together)

⚠ Caution!

- Press the two button also to be released the function.
- The " Child Lock " will lock all buttons except [On/Off].

OPERATIONS

■ Personalized Setting of Washing Program

Customers can select washing program according to actual demand, and set rinsing times, water level and appointment time.

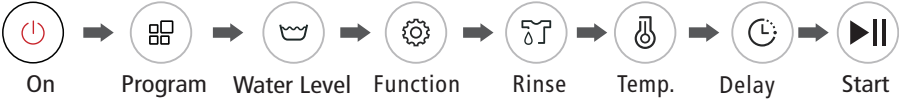

■ Operations of Washing Process

Customers can set single process or combinations of washing, rinsing and spinning freely according to demand. Detailed operations as follows for different models:

One Touch Smart Wash



Washing Process

Spin



Wash + Rinse + Spin

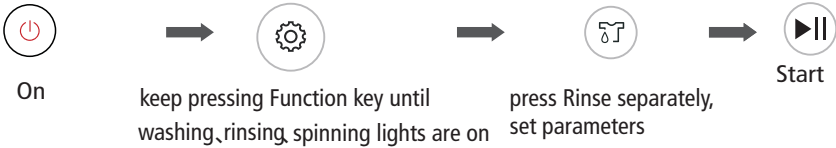

📌 Note!

- Note: other process combinations are just like above.

OPERATIONS

■ Washing Programmes Table

Light Flash

XXXX □ XXXX

XXXX □ XXXX

XXXX □ XXXX

XXXX □ XXXX



Program

Programmes are available according to the laundry type.
Only for washers having these function

Programmes

Jeans: Suitable to wash heavy stained/wearable clothes.

Quick 15': Suitable to wash light stained clothes and clothes in summer.

Soft: The tempo is soft, slow washing and spinning speed, to assist in preventing creasing and deformation.

Mix Suitable to wash cotton ,linen ,flax. jute clothes

Normal (Standard) Standard fabric washing program, suitable to wash ramie cotton fabric. Wash for once, rinsing for once, the spin time is a little longer. (Please refer to Technical Specifications for more details).

Strong The wash time is longer, the stream is stronger, so the washing effect is better.

Heavy Suitable to wash heavy stained/wearable clothes.

» **FCS** Start up Fast Clean System : Power on, select "Normal", "Heavy", "Mix", "Strong", "Jeans" program, then press FCS button. then press "Start/Pause" button, FCS function starts up. The relative figures will be showed after FCS function starts up. Cancellation of FCS function: when the FCS function was selected, The function can be cancelled by pressing FCS button or power off.

Fuzzy weighting: The washing machine will select the water level automatically according to the load weight.
1. When there's water in the tub, this function is not available;
2. Before press [Start/Pause] button, if consumer selected the water level, there will be no fuzzy weighting function;
3. After press [Start/Pause] button, the washing machine will run the fuzzy weighting function. Consumer can also select the water level to set the water level as needed.

MAINTENANCES

■ Cleaning And Care

⚠ Warning!

- Before your maintenance starts, please unplug the machine and close the tap.

■ Cleaning the Cabinet

Proper maintenance on the washing machine can extend its working life. The surface can be cleaned with diluted non-abrasive neutral detergents when necessary. If there is any water overflow, use the wet cloth to wipe it off immediately. No sharp items are allowed.

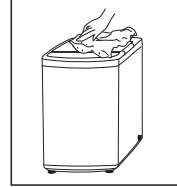

📌 Note!

- Formic acid and its diluted solvents or equivalent are forbidden, such as alcohol, solvents or chemical products, etc.

■ Cleaning the Inlet Filter

📌 Note!

- **Inlet filter must be cleaned if there is low water pressure.**

Washing the filter in washing machine:

1. Screw off the inlet pipe from the backside of the machine.
2. Pull out the filter with long nose pliers and reinstall it back after being washed.
3. **Use brush to clean the filter.**
4. Reconnect the inlet pipe.

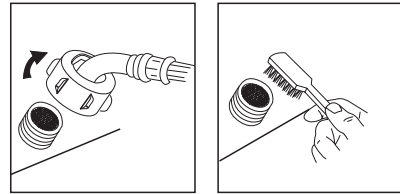

Lint filter clean

1. There is a built-in lint filter in your washer. It can help to collect lint during washing cycle.
2. It is suggested to clean the lint filter every 10 cycles.
3. Take it out and clean the filter with water. Then place it back into the washer.

magic filter

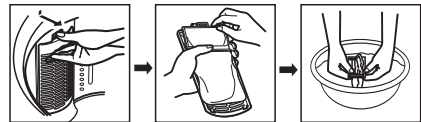

MAINTENANCES

■ Cleaning Drain Pump Filter

⚠ Warning!

- Be careful of the hot water!
- Allow detergent solution to cool down.
- Unplug the machine to avoid electrical shock before washing.
- Drain pump filter can filter the yarns and small foreign matters from the washing.
- Clean the filter periodically to ensure the normal operation of washing machine.

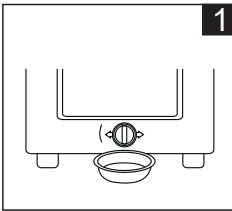

1
Drain the water out of the pump, under which use a container to collect.

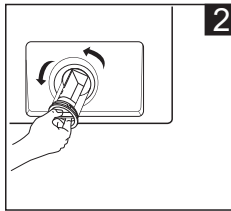

2
Open the filter by turning to the counter clockwise

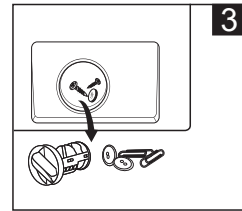

3
Remove any foreign matter

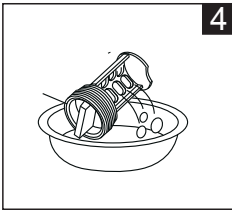

4
Clean the filter.

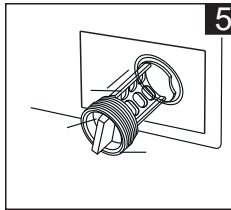

5
Restore it and adjust the convex place to align at the pump hole.

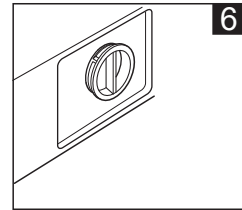

6
Tighten the pump cover clockwise.

⚠ Caution!

- Make sure that valve cap and emergency drain hose are reinstalled properly, cap plates should be inserted aligning to hole plates otherwise water may leak;
- Some machines don't have emergency drain hose, so step 2 and step 3 can be skipped. Rotate lower cover cap directly to make water run into basin.
- When the appliance is in use and depending on the programme selected there can be hot water in the pump. Never remove the pump cover during a wash cycle, always wait until the appliance has finished the cycle, and is empty. When replacing the cover, ensure it is securely re-tightened.

MAINTENANCES

■ Trouble Shooting

Should your appliance fail to work or it stops during operation. First try to find a solution to the problem, If not, contact the service centre.

Description	Inspection Items
No washing	<p>If the power is off or the fuse is burned out. If the power supply voltage is too low. If the water amount reaches to the required water level. (The washer will not work if the water amount does not reach the required water level) If it is set to "Delay" washing mode. (It will only start to work until the reservation time reached).</p>
No water flows in	<p>If the power is off or the fuse is burned out. If the water supply is cut off or the water pressure is too low. If the inlet hose is properly connected and the water tap is opened. If the filtering screen of inlet valve is blocked by dirt. If the coil of inlet valve is damaged. (The slight electromagnetic sound is normal phenomenon when the inlet valve is switched on) If the "Start / Pause" button is pressed after the power switch is pressed.</p>
Abnormal draining	<p>If the water drain hose is placed very high. If the end of water drain hose is submerged in laundry tub due to blocked drain. If the internal rubber ring of drain valve is blocked by dirt.</p>
Abnormal spin	<p>If the door lid is open. If all clothing piled largely at one side of barrel or the clothing is excessively placed. If the washer is not placed in stable condition or it is placed on uneven ground. (The ground is not flat). If the motor belt is loosened.</p>

Description	Reason	Solution
E1	Alarm for abnormal water intaking.	Check the water tap is opened or not and the inlet filter is clean.
E2	Alarm for water drain has not finished.	Check the water level sensor and drain pump filter.
E3	Alarm for lid not closed before wash and spin.	Closed the lid. Press "Start" button.
E4	Alarm for unbalanced wash load	Manually balance clothes in the barrel by hands.
EXX	Others	Please try again first, call up service line if there are still troubles

Note!

- After the check, activate the appliance. If the problem occurs or the display shows other alarm codes again, contact the service **centre**.

MAINTENANCES

Technical Information

■ Technical Specifications

Model	TWM55TCM	
Rated Power	400W	
Classification of use	Indoor use only	
Rated Total Gross Volume (L)	5.5 Kg	
Voltage (V)	240	
Frequency (Hz)	50	
Washing Type	Pulsator	
Water Pressure	0.03 - 0.8 MPa	
Max. Spin Speed	600 RPM	
Dimensions (mm)	Height	910
	Width	515
	Depth	525
Net Weight (Kg)	31 Kg	
IP rating	IPX4	

Note!

This product is subject to continuous improvement, specifications are subject to change without prior notice.

Energy efficiency test program **for TWM55TCM:**

During "Normal" washing program the default setting is water level 6, warm temperature, which is suitable for a normally soiled load.

MAINTENANCES

Technical Information

■ Technical Specifications

Model	TWM70TCM	
Rated Power	450W	
Classification of use	Indoor use only	
Rated Total Gross Volume (L)	7 Kg	
Voltage (V)	240	
Frequency (Hz)	50	
Washing Type	Pulsator	
Water Pressure	0.03 - 0.8 MPa	
Max. Spin Speed	600 RPM	
Dimensions (mm)	Height	935
	Width	550
	Depth	565
Net Weight (Kg)	38 Kg	
IP rating	IPX4	

Note!

This product is subject to continuous improvement, specifications are subject to change without prior notice.

Energy efficiency test program **for TWM70TCM**:

During "Normal" washing program the default setting is water level 5, warm temperature, which is suitable for a normally soiled load.

MAINTENANCES

Technical Information

■ Technical Specifications

Model	TWM100TCM	
Rated Power	600W	
Classification of use	Indoor use only	
Rated Total Gross Volume (L)	10 Kg	
Voltage (V)	240	
Frequency (Hz)	50	
Washing Type	Pulsator	
Water Pressure	0.03 - 0.8 MPa	
Max. Spin Speed	600 RPM	
Dimensions (mm)	Height	1000
	Width	601
	Depth	630
Net Weight (Kg)	45Kg	
IP rating	IPX4	

Note!

This product is subject to continuous improvement, specifications are subject to change without prior notice.

Energy efficiency test program for **TWM100TCM**:

During "Normal" washing program the default setting is water level 8, warm temperature, which is suitable for a normally soiled load.

MAINTENANCES

■ Repairs, Service & Warranty

It is hazardous for anyone installing, removing, altering, repairing, servicing or testing of this appliance.

Only an Authorised Service Person can carry out servicing or repairs to this appliance.

IF SERVICE IS REQUIRED:

If you have a problem, and the problem persists after you have made the checks mentioned in this manual, contact: TECOAustralia's Service on 1300 660 037 (8:30am - 4pm Mon~Fri AEST)

For warranty details please visit www.teco.com.au

Service Email: had.service@teco.com.au

Spare Parts: had.parts@teco.com.au

Did you know?

TECO Australia's product range also includes:

- ◆ Top Load Clothes Washers
- ◆ Front Load Clothes Washers
- ◆ Auto Sensing Vented Clothes Dryers
- ◆ Refrigerators
- ◆ Chest and Vertical Freezers
- ◆ Bar Fridges
- ◆ Televisions
- ◆ Air Curtains
- ◆ Air Conditioners

Visit **www.teco.com.au** for our full range.



WARRANTY INFORMATION

Teco's warranty information for the product purchased is available at www.teco.com.au.

A copy of the warranty may also be obtained by contacting Teco's Warranty and Service Department on 1300 660 037 during business hours (Mon - Fri 8.30am – 4pm AEST).

To arrange for servicing of a Teco product, please contact our Warranty and Service Department on 1300 660 037 during business hours (Mon - Fri 8.30am – 4pm AEST).

To assist in processing any warranty claim that you may have Teco recommends that you:

1. Complete the following information in relation to your purchase:

Name of retailer: _____

Name of owner: _____

Date of purchase: _____

Model No. : _____

Serial No. : _____

MFG code: _____

2. Retain proof of your purchase for any warranty claim. Ideally this proof of purchase will be the tax invoice issued for your purchase.
3. Complete the following information in relation to the person that installed your Teco appliance (if applicable):

Installer's name: _____

Telephone No.: _____

Licence No.: _____



www.teco.com.au